

Service Information

MACHINE TYPE : FS-8mm Feeder

No: SI0707007E-000
ISSUED DATE: 8/6/2007

CLASSIFICATION : Installation

FS-8mm Feeder: How to set the taped components to the feeder

This document describes the procedures; from the unpacking process of the FS feeder to setting the taped components to it.

1 Unpack the FS feeder and attach the reel holder

1. Open the shipping box and take out the feeder body and reel holder. (The screws for fixing and washers are supplied with the reel holder.)
2. Attach the reel holder to the body.

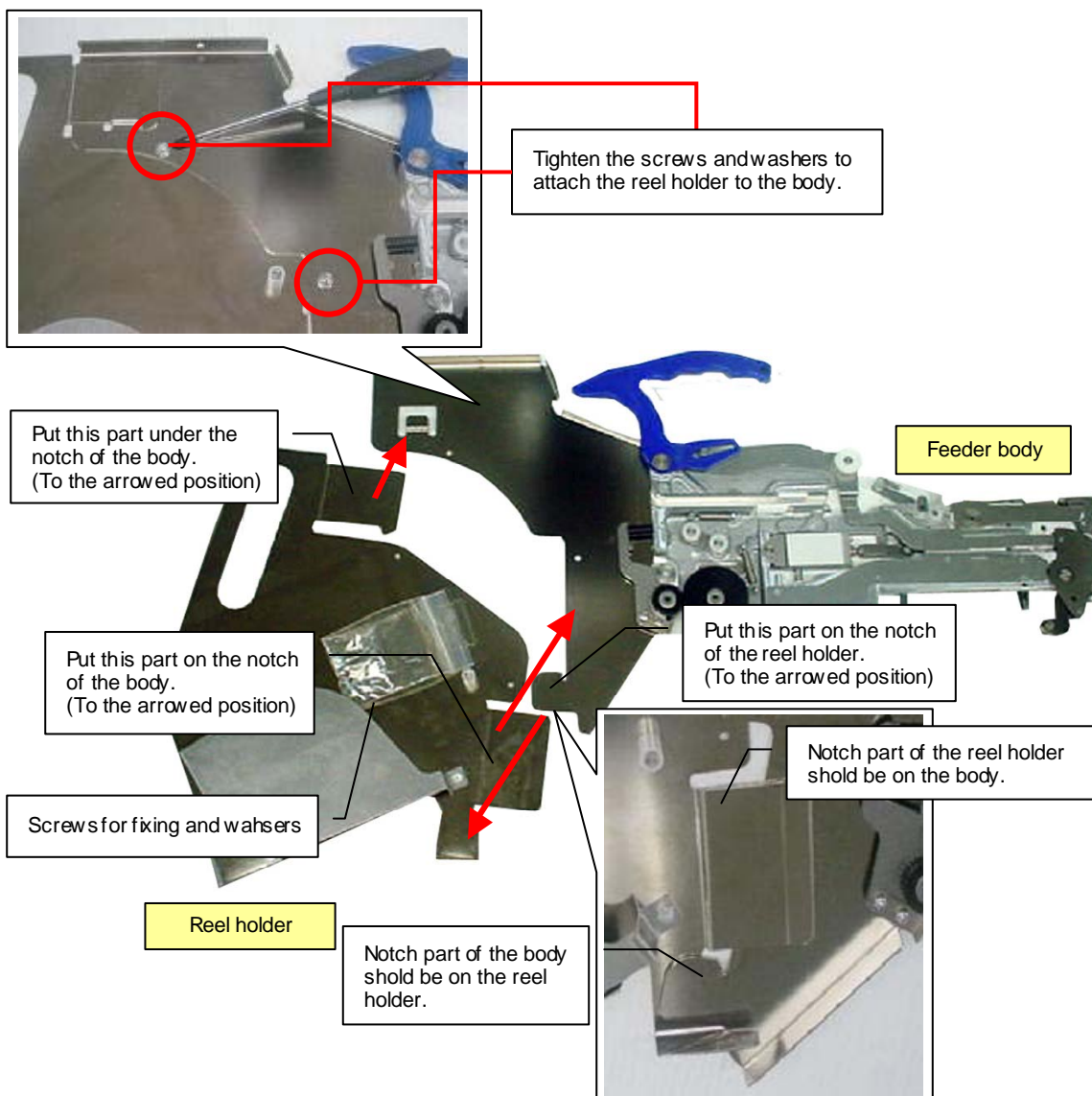

Fig 1

Service Information

2 Procedures to set the tape component

1. Put the reel in the pocket of the reel holder and pull out the tape somewhat.
2. While lifting the handle lever up, push down the locking lever in the tip of the tape guide. And then, lift the tape guide up.

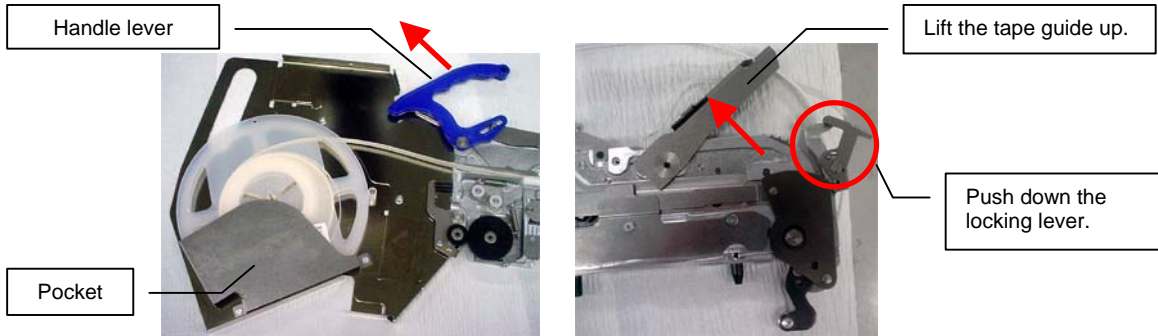

Fig 2

3. Feed the top tape through the tape guide in order of 1 to 5 described in Fig.3.

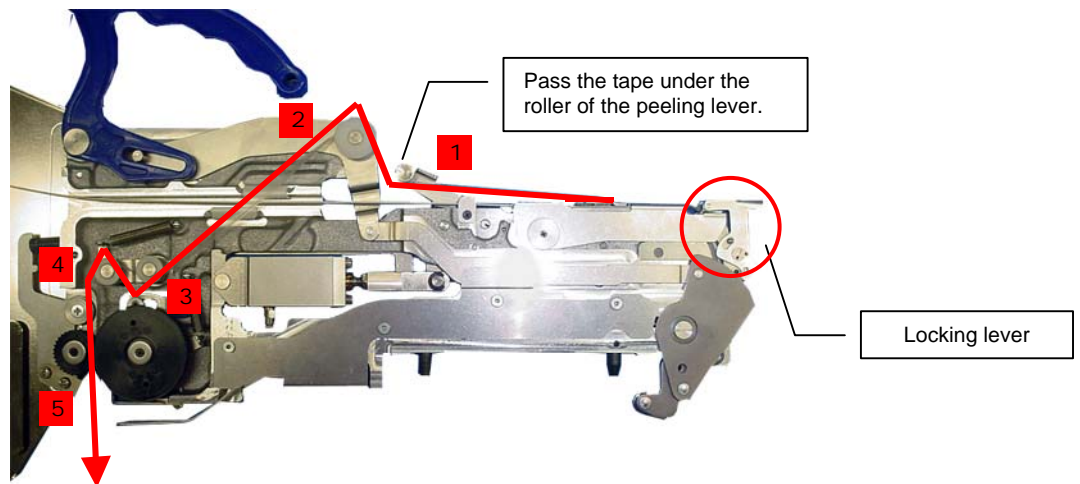

Fig 3

4. Push down the tape guide and get the locking lever back.(Fig 3) When lowering the tape guide, set the carrier tape so that the gear can engage with the holes in the carrier tape.
5. Pull down the top tape until the two rollers become level.(Fig 4 Left)
6. Push the bending part of the peeling lever(Fig 4 Right) to feed the component to the pickup position.

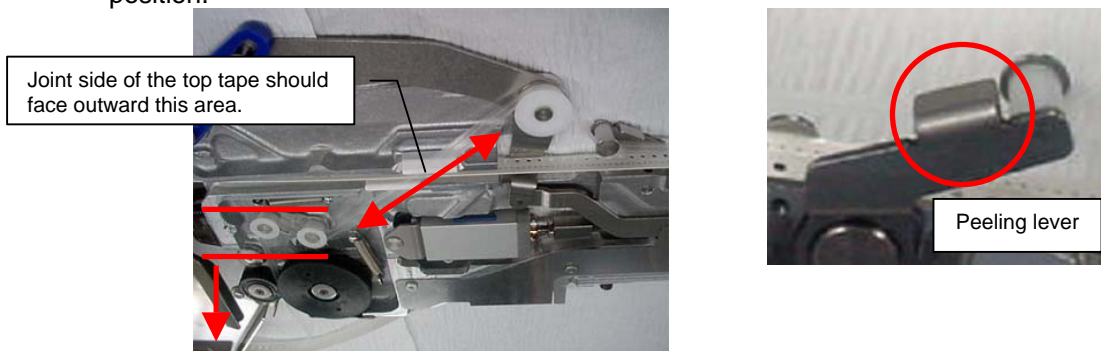

Fig 4